

Warranty

Whilst every Lucent product is manufactured to the highest quality standards, we offer a comprehensive Warranty for complete peace of mind.

Residential Use

15 Years Replacement products or parts
10 Years Finish / 5 Years Matte Black
1 Year Labour

Commercial Use

5 Years Replacement products or parts
1 Year Labour

Warranty may become void due to any of the following:

- Inability to provide proof of purchase or equivalent documentation
- Product not installed by a licensed Plumber
- Failure to install product to national standards and state regulations
- Failure to install product in accordance with manufacturers installation instructions
- Fitting of non-approved flow controllers in tap bodies or outlets
- If products are used for outdoor applications.
- Product used for non-potable water applications.
- Damage because of insufficient flushing of lines prior to installation. Service, repairs, or installation of non-Lucent replacement parts undertaken without Lucent's prior written approval.
- Damage to finishes caused by non adherence to cleaning instructions.

Cleaning Instructions:



CLEAN MICROFIBRE
CLOTH



SOAPY WATER



PH BALANCE
SOAP - BASED
CLEANSER

Warranty Service

For all warranty service calls please contact your local store.
Phone: 1300 474 714
E-mail: warranty@lucentdesigns.com.au



INS_1027.pdf rev.1.0

LUCENT[®]

Installation and Operating Instructions

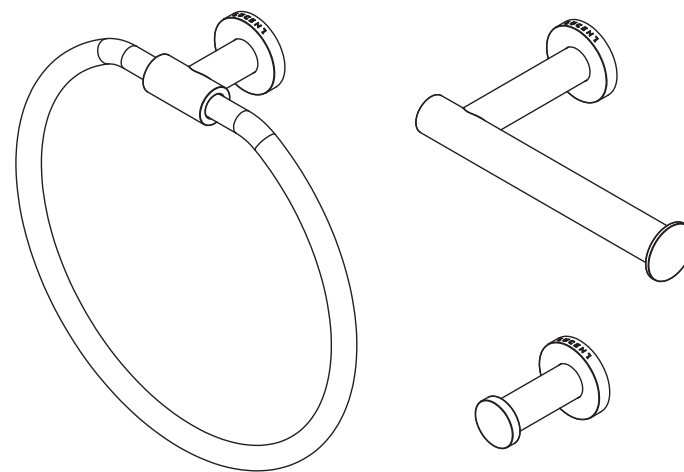

90901
TOILET ROLL
HOLDER

90905
TOWEL RING

90911
ROBE HOOK

Thank you for purchasing a quality Lucent product. Please note that this product must be installed by a qualified and registered plumber who is compliant with all the relevant regional requirements and who holds current certification.

Note: Please read all instructions prior to installation to limit warranty disputes should a claim arise.

Installation Instructions

Note to Plumber: Please provide this leaflet to the owner after installation.

STEP 1

Ensuring the accessory mount hole is facing the floor, using appropriate hardware, fix the base plate to the wall.

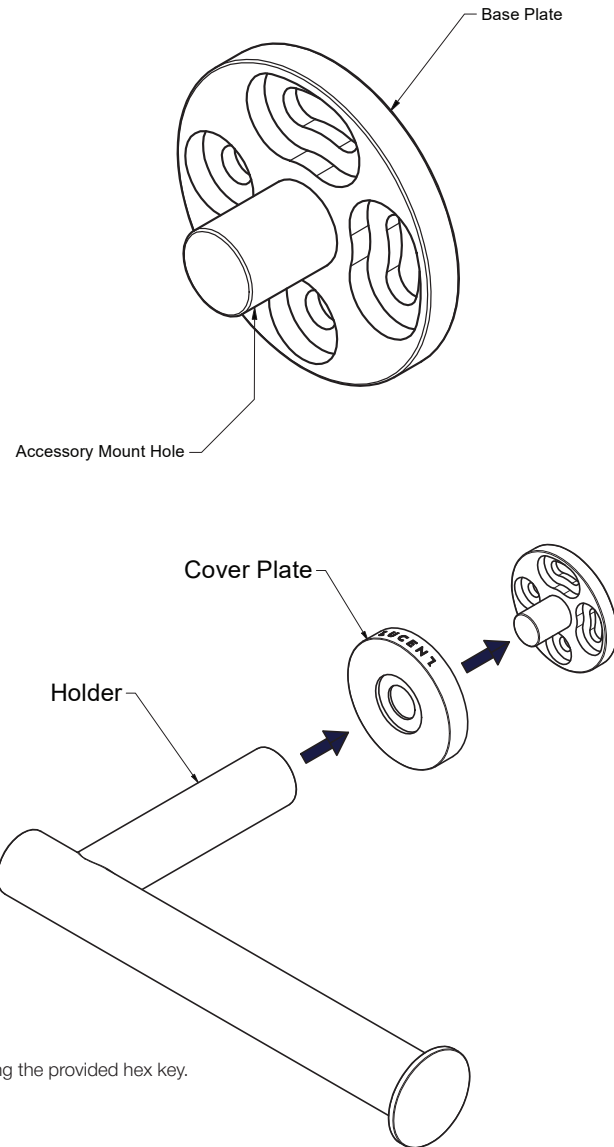

STEP 2

Secure the screws using the provided hex key.

STEP 3

Push the cover plate and holder onto the base plate.

Note: Holder styles may vary.

